

# A1

STEREO  
EARPHONE

User Manual

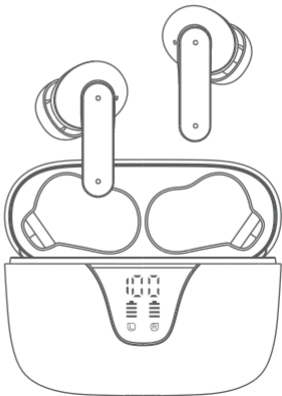

# Contents

<b>Packing List</b>	1
<b>Product Overview</b>	2
<b>Wear</b>	3
<b>Pairing</b>	4
<b>Power On</b>	5
<b>Power Off</b>	6
<b>Phone Calls Control</b>	7
<b>Music</b>	8
<b>Activate "Siri"</b>	9
<b>Charging</b>	9 - 11
<b>Specification</b>	12
<b>Safety Instruction</b>	13
<b>Q&amp;A</b>	14 - 18

# Packing List

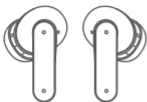

Earbuds



Ear Caps \*6[L\M\S]

**NOTE:**

The medium size is on the earbuds



Charging Case

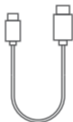

USB Charge Cable



User Manual

## Package Contents:

- A. Earbuds x 2
- B. Ear Caps x 6 (L\M\S)
- C. Charging Case x 1
- D. USB Charge Cable x 1
- E. User Manual x 1

## Product Overview

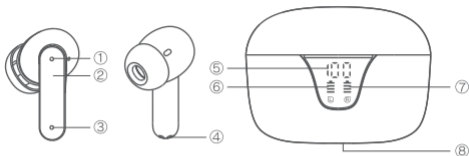

① Earphone indicator

② Touch button

③ Call microphone

④ Earphone charging port

⑤ Charging case digital display

⑥ Left earphone digital display

⑦ Right earphone digital display

⑧ Type-C charging port

If any questions are not answered in the manual, please check the product description on Amazon (FAQ at the product listing bottom), or contact our store customer service team through the Amazon platform, we will reply within 24 hours

# Wear

1. **Choose the right ear tip size:** earbuds come with 3 ear tip sizes to accommodate different ear sizes. It's important to choose the right size for your ears, as a loose or tight fit can affect sound quality and comfort.



2. **Insert the earbuds correctly:** insert them into your ear canal and twist them slightly to secure them in place. The earbuds should sit comfortably and snugly in your ears, without feeling too tight.
3. **Position the earbuds correctly:** The earbuds should be positioned so that they're facing forward and pointing towards your ear canal. If they're not positioned correctly, you may experience a loss of sound quality or difficulty keeping them in place.



4. **Take breaks:** Wearing earbuds for an extended period of time can be uncomfortable and potentially harmful to your ears. Make sure to take breaks every few hours to give your ears a rest.

# Pairing

## Stereo mode

1. Open the charging case and take out the earphones from the charging case, the two earbuds **will** automatically turn on and connect to each other, waiting to connect to your phone.
2. Turn on your phone's Bluetooth and search for "A1", then choose "A1". The earbuds **will** connect to your phone.

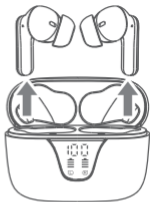

## Single Earbud Mode

1. Take an earbud (left/right) out of the charging case.
2. Turn on your phone's Bluetooth and select "A1". The earbud **will** connect to your phone.



## Note:

- A. After the earbuds is disconnected from the mobile phone, it will automatically enter the pairing state and shut down after 5 minutes.
- b. When there is a pairing record, just remove one or two earbuds from the charging case, and the earbuds **will** automatically connect to the phone.

# Power On

## Auto Power On

Take out the earphones from the charging case, and they will “power on” automatically.

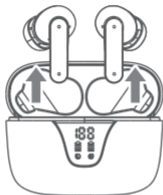

## Manual Power On

When the earphones are OFF, keep the touch button of both earphones for 3-5 seconds with a sound prompt: “power on”.

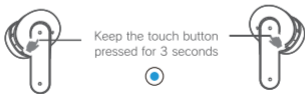

# Power Off

## Method 1:

The earphones will switch off when put into the charger case.

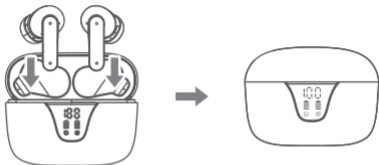

## Method 2:

Keep the earphones touch button pressed for 3-5 seconds, until a sound prompt: "power off".

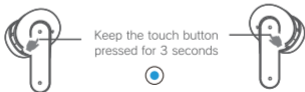

## NOTE:

If the earphones were disconnect with the device, the earphones will be power off automatically after 5mins.

# Phone Calls Control

**Answer/End Calls:** Short tap one of the touch buttons.



**Reject Calls:** Long press one of the touch buttons



During a call, the volume can be controlled via the mobile phone.

# Music

## Play/Pause:

Tap the button once to Pause/Play.

TAP ONCE



## Next Song:

Keep pressing the touch button of "Right Earbud" for 1 seconds and release it.

KEEP 1 SECONDS



## Previous Song:

Keep pressing the touch button of "Left Earbud" for 1 seconds and release it.

KEEP 1 SECONDS



## Volume Up:

Tap the button of "Right Earbud" twice to increase the volume.

TAP TWICE



## Volume Down:

Tap the button of "Left Earbud" twice to decrease the volume.

TAP TWICE



## Note:

When the volume is set to maximum/minimum, you will hear a voice prompt "Volume Maximum" / "Volume Minimum".

# Activate "Siri"

Tap the button three times to activate the Siri voice assistant.



# Charging

## Digital Power Display



Charging case power display



## Earbuds Charging

Put the earbuds into the charging case and close the case. The earbuds light will stay blue, and light off after fully charged.

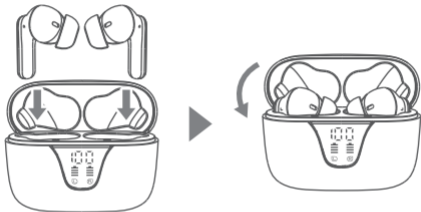

### Note:

- A. Please take care when you put earbuds into the case. Place them in the right position and if not please adjust them lightly until achieving successful charging.
- B. Power level 10% starts to alarm, there will be a voice prompt " Battery is Low Please Charge" every 20s, and the blue light slowly flash.

## Charging for the Case

Use the type-c charging cable(provided) to connect your computer(with power on) or an adapter(not provided) to your charging case. The charging case power display will be 100% after fully charged.

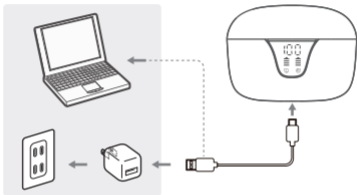

### NOTE:

- \* Please separate the charging cable and charging cable when fully charged.
- \* 5V adapter is the best choice for charging to avoid battery damage. Improper current and voltage may damage earbuds and charging case and thus warranty is not valid.

## Specification

Model:	A1
Version:	V5.3
Operating Mode:	Touch Function
Voltage rating and energy capacity:	3.7V/400mAH
Charging Case Battery Capacity:	400mAh
Battery capacity:	2*3.7/40mAH
Earphone Charging Time:	1H
Charging Case Charging Time:	2H
Music playing Time:	About 4-5h*4times
Supporting Protocols:	HSP/HFP/A2DP/AVRCP
Operating frequency:	2.40 GHZ-2.48 GHZ
RF sensitivity:	-92dBm
Working temperature range:	-10+50°C
Maximum transmission range:	≤ 15M

## Safety Instruction

- When using while walking, pay close attention to the surrounding traffic. It may cause a traffic accident.
- Minimize the volume before use. Sudden loud noises will impair your hearing.
- To protect your ears, do not turn up the volume too much.
- If the product drop into a flammable or liquid such as water, please stop using it and contact the store where you purchased the product or us. If you still continue to use it, it may cause a fire, malfunction or electric shock.
- Opening the inside may cause a malfunction or electric shock. Do not touch the inside. In addition, we do not guarantee performance if the inside is modified by people.
- Do not charge it with wet hands or touch the charging port. It may cause electric shock.
- If you feel sick while using this product, please stop using it immediately.
- If you are using a medical device such as a pacemaker, consult your doctor before using it.
- Do not allow small children to use it.
- Host device is a connection between second device and your mobile phone, it is normal status under high power consumption.

## Q&A

### **If you're having trouble connecting your Bluetooth earbuds to your computer/tablet, there are a few things you can try:**

- \* Make sure your computer's Bluetooth is turned on - Check your device's settings to ensure that Bluetooth is enabled. If it's not, turn it on and try connecting your earbuds again.
- \* Restart your computer: Sometimes a simple restart can fix connection issues. Try restarting your computer and then attempting to connect your earbuds again.
- \* Update your computer's Bluetooth drivers: If your computer's Bluetooth drivers are out of date, this can cause connection issues. Check the manufacturer's website for the latest drivers and install them.
- \* Try connecting to a different device: If you have another device that you can connect your earbuds to, such as a smartphone or tablet, try connecting to that device to see if the issue is with your earbuds or your computer.

### **Bluetooth earbuds can sometimes have trouble connecting to your device or maintaining a stable connection. This can be due to interference from other wireless devices, low battery, or outdated software. There are several things you can try to improve the situation:**

- \* Restart both your earbuds and the device you are trying to connect them to.

- \* Make sure your earbuds are fully charged and in pairing mode and that your earbuds are not automatically connected to other devices.
- \* Disable any other Bluetooth devices that may be interfering with the connection or changing the use environment.
- \* Check for any software updates for your device, and install them if available.

**It is possible for the audio quality of Bluetooth earbuds to deteriorate over time with use. There could be several reasons for this issue:**

- \* **Low battery:** When the battery of the earbuds is low, the audio quality may decrease. This is because the earbuds are not able to transmit or receive signals effectively when the battery is low.
- \* **Interference:** Bluetooth earbuds use radio waves to transmit audio signals. If there are other electronic devices nearby that also use radio waves, such as Wi-Fi routers or microwaves, they can cause interference and reduce the quality of the audio.
- \* **Physical damage:** If the earbuds have been dropped or exposed to moisture, the internal components may be damaged, which can affect the audio quality.
- \* **Connection issues:** Sometimes, the Bluetooth connection between the earbuds and the device they are paired with can become unstable over time. This can cause the audio to cut out or sound distorted.

**If you are often accidentally pressing the button on your wireless earbuds when you try to adjust them, there are a few things you can do to try to avoid accidentally hitting the button:**

- \* Use a different grip - Try adjusting your earbuds with a different grip. If you are using your fingers to adjust them, try using your thumb instead, or vice versa. This might help you avoid accidentally hitting the button.
- \* Practice adjusting them - Spend some time practicing adjusting your earbuds so that you can do it without looking at them. This will help you avoid accidentally hitting the button because you'll be more aware of where it is.

**To improve the audio quality of Bluetooth earbuds, try the following:**

- \* Charge the earbuds fully before using them.
- \* Clean the charging contacts, and mesh of ear tips with an alcohol pad to remove dust or earwax that might be affecting charging or sound volume.
- \* Keep the earbuds away from other electronic devices that use radio waves.
- \* Avoid exposing the earbuds to moisture.

## **If your earbuds frequently come out of your ear. There are a few things you can try to keep your earbuds in place:**

- \* Adjust the ear tips: Earbuds come with different sizes of ear tips. Try different sizes to find the ones that fit your ears the best. (If our spare earbuds are not available in your size, you can search for the keyword "Eartip replacement" on Amazon and choose the size that best suits you to buy).
- \* Twist the earbuds: earbuds are designed to be twisted slightly into your ear canal. This can help keep them in place.

## **If the charging case is not charging the earbuds:**

- \* Make sure your case is fully charged.
- \* Make sure the earbuds are properly plugged in or the case has enough battery to charge the earbuds.
- \* Check the charging ports on both the earbuds and the charging case for any debris or damage. Clean the ports with a soft, dry cloth if necessary.

## **If you're having trouble charging the case, here are some things you can try:**

- \* Make sure that the charging cable you are using is compatible with the charging case and is not damaged. If the cable is damaged, try using a different one.
- \* Check the charging ports on both the charging case and the cable for any debris or damage. Clean the ports with a soft, dry cloth if necessary.

- \* Try using a different power source, such as a different USB port or a wall adapter, to charge the charging case. If the charging case is not charging with one power source, it may work with another.
- \* We recommend that you use a 5v adapter to avoid damaging the battery.

**If none of these solutions work or lack of parts when you receive the package or there are other problems are not mentioned, Please contact brand support for further assistance by following the steps:**

1. Go to the Amazon website and log in to your account.
2. Click on the "Orders" button located on the top right corner of the screen.
3. Locate the order that you need help with and click on the "Contact Seller" button.
4. Choose the reason for your inquiry from the drop-down menu and provide a brief description of your issue.
5. Click on the "Send" button to submit your message to us.
6. Alternatively, you can also go to the seller's storefront on Amazon and click on the "Ask a Question" button located on the top right corner of the screen. This will allow you to send a message directly to us.

It's recommended to be as clear and concise as possible when describing your issue to us. This will help us understand your problem and provide you with the best possible solution.